

NEW!

Introducing Precision-Formed Female Signal Contacts for the Goldfish Connector Series.

A Lower Cost and Lower Mating force signal contact option.

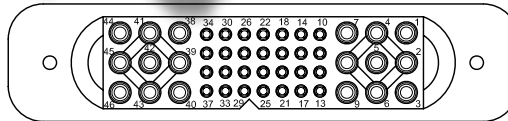
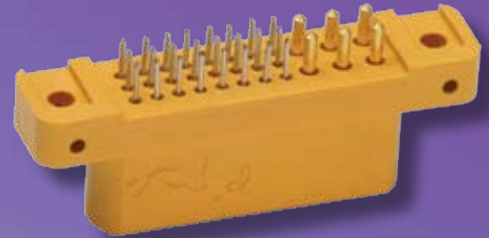

GFSH928F-Series: Fully-populated with Eighteen (18) Size 16 power contacts and Twenty-eight (28) Size 22 signal contacts.*

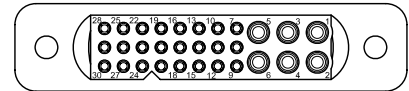

GFSH624F-Series: Fully-populated with Six (6) size 16 power contacts and Twenty four (24) size 22 signal contacts.*

GOLDFISH SERIES

With Precision-Formed Female Signal Contacts

Materials and Finishes:

- Insulator: Glass-filled nylon, UL 94V-0.
- Size 16 Contacts: Precision machined copper alloy with gold over nickel plate.
- Size 22 Contacts: Precision formed copper alloy with selective gold over nickel plate at mating end, and tin over nickel plate at termination end.

Electrical Characteristics:

- Contact Current Ratings (per UL 1977):
 - Size 16 Contacts: 20 amperes, continuous. (standard contacts)
30 amperes, continuous. (high conductive contacts).
 - Size 22 Contacts: 1 amperes, nominal.
- Initial Contact Resistance (max.) per IEC 512-2, Test 2b:
 - Size 16 Contacts: 0.003 ohms. (standard contacts).
0.001 ohms. (high conductive).
 - Size 22 Contacts: 0.009 ohms.
- Insulator Resistance (per IEC 512-2, Test 3a): 5 G ohms min.

Proof Voltage:

- Power Contacts: 1500 V r.m.s. (GFSH928)
1300 V r.m.s. (GFSH624)
- Signal Contacts: 1000 V r.m.s.

Working Voltage

- Power Contacts: 500 V r.m.s. (GFSH928)
150 V r.m.s. (GFSH624)
- Signal Contacts: 333 V r.m.s.

Mechanical Characteristics:

- Blind Mating System: Molded in guides allow for misalignment up to 2.00 mm [0.079 inch].
- Polarization: Provided by insulator.
- Fixed Contacts: Size 16 female contacts feature "closed entry" 1,000 cycles design for both straight & right angle (90°) PCB mount. Size 22 female contacts feature "open entry" 250 cycle design (for both straight & right angle (90°) PCB mount.
- Contact Retention in insulator (fixed):
 - Power Contacts: 45 N [10 lbs.] min.
 - Signal Contacts: 27 N [6 lbs.] min.
- Climatic Characteristics:
 - Working temperature: -55° to +125°C.

* To order specify PA688 in step 6 of the GOLDFISH ordering information for female connectors with precision formed signal contacts.
Contact sales for more details.



POSITRONIC
GLOBAL *Connector* SOLUTIONS

Contact Termination Dimensions

Goldfish 928 Right Angle (90°) PCB Mount

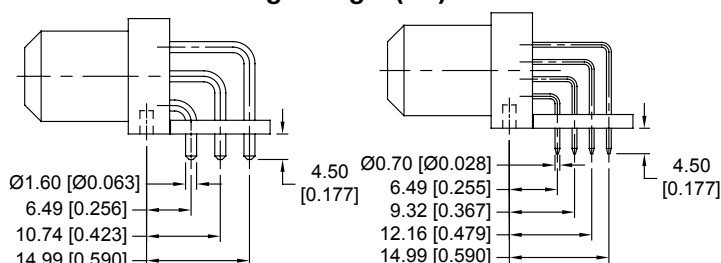

Size 16 contacts

Size 22 contacts

Goldfish 624 Right Angle (90°) PCB Mount

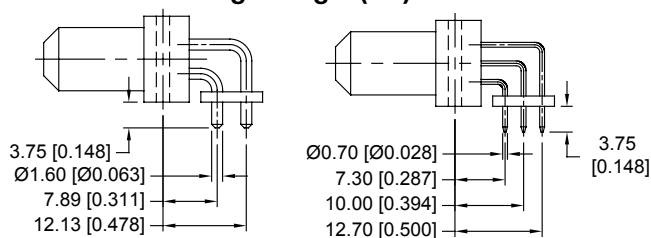

Size 16 contacts

Size 22 contacts

Goldfish 928 Straight PCB Mount

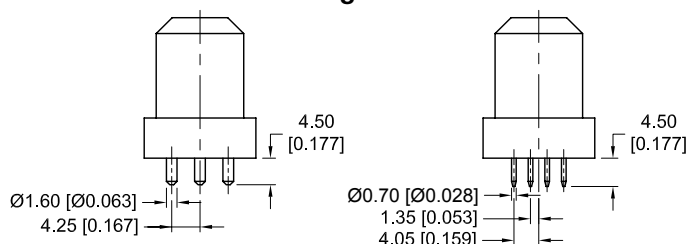

Size 16 contacts

Size 22 contacts

Goldfish 624 Straight PCB Mount

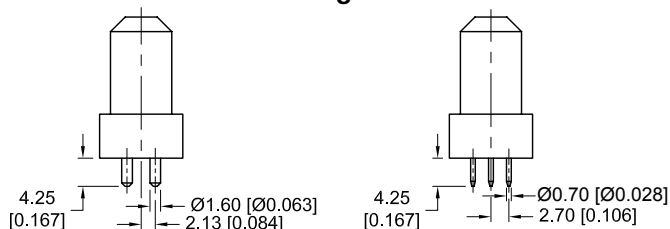

Size 16 contacts

Size 22 contacts

Contact Hole Patterns

Goldfish 928 Right Angle (90°) PCB Mount

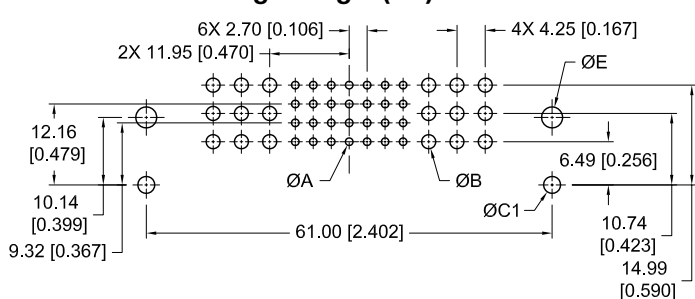

Goldfish 624 Right Angle (90°) PCB Mount

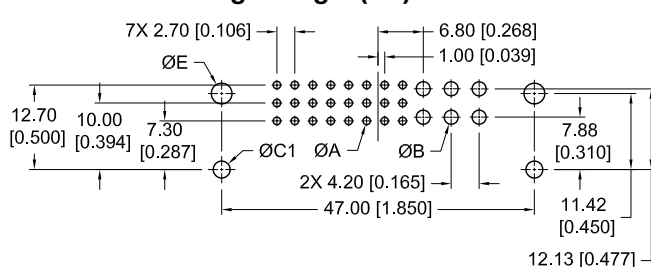

Goldfish 928 Straight PCB Mount

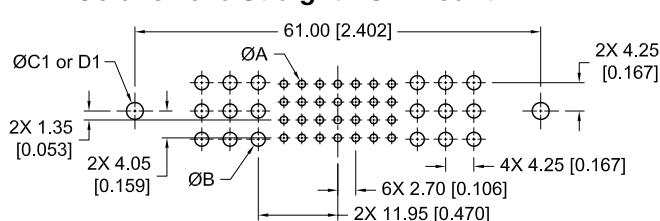

Goldfish 624 Straight PCB Mount

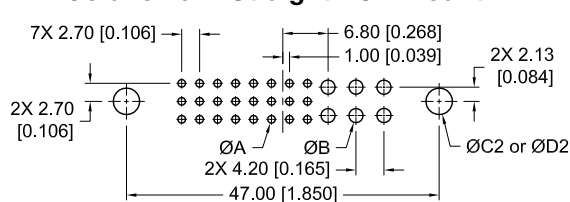

DIM Suggested size

A	Ø1.14 [0.045]
B	Ø2.11 [0.083]
C1	Ø2.54 [0.100]
C2	Ø3.96 [0.156]
D1	Ø3.12±0.08 [0.123±0.003]
D2	Ø3.96±0.08 [0.156±0.003]
E	Ø3.12 [0.123]

For use

Size 22 contact terminals.
Size 16 contact terminals.
Mounting connector with screws.
Mounting connector with screws.
Mounting connector with push-on fasteners.
Mounting connector with push-on fasteners.
Mounting connector with push-on fasteners.

Specify PA688 in step 6 of GOLDFISH ordering information for connector with precision formed signal contacts.

Example: GFSH928F4H-PA688.

Available in female connectors only.

POSITRONIC INDUSTRIES, INC

423 N Campbell Avenue, P O Box 8247,
 Springfield, MO 65801, USA
 Telephone: 1 417 866 2322
 Fax: 1 417 866 4115
 Email: info@connectpositronic.com

POSITRONIC INDUSTRIES, SAS

Zone Industrielle Est, 46 Route
 d'Engachies,
 F32020, Auch Cedex 9, France
 Telephone: 33 (0) 5 62 63 44 91
 Telecopieur: 33 (0) 5 62 63 51 17
 Email: contact@connectpositronic.com

POSITRONIC ASIA PTE LTD

3014A Ubi Road 1 # 07-01
 Singapore 408703
 Telephone: 65 6842 1419
 Fax: 65 6842 1421
 Email: singapore@connectpositronic.com